

Cintropur filters and accessories

Cintropur

Ref.	Description	Connection	€/uni.
VF1037	Cintropur NW500 Cintropur housing NW-500	2"	
VF1038	Cintropur NW650 Cintropur housing NW-650	2½"	
VF1039	Cintropur NW800 Cintropur housing NW-800	3"	

Features system:

- Head made of polypropylene.
- Transparent Glass.
- Operating temperature between 0°C and 50°C.
- Include gauge.
- Made entirely of high quality synthetic materials.
- Filters Cintropur are perfectly suitable for food products and drinkable water.
- The centrifugal propeller Cintropur transforms water flow in a centrifugal movement, precipitating particles to the bottom of the vessel, while the filter mesh ensures final filtration in accordance with the chosen micron.



	VF1037	VF1038	VF1039
· Connection:	2"	2½"	3"
· Average flow $\Delta P=0,2b$:	18 m³/h	25 m³/h	32 m³/h
· Pressure:	10 bar	10 bar	10 bar
· Max. working pressure:	16 bar	16 bar	16 bar
· Max. temperature:	50°C	50°C	50°C
· Filter mesh (originally):	25µ	25µ	25µ
· Dimensions (high):	770 mm	770 mm	770 mm
· Dimensions (large):	363 mm	304 mm	313 mm

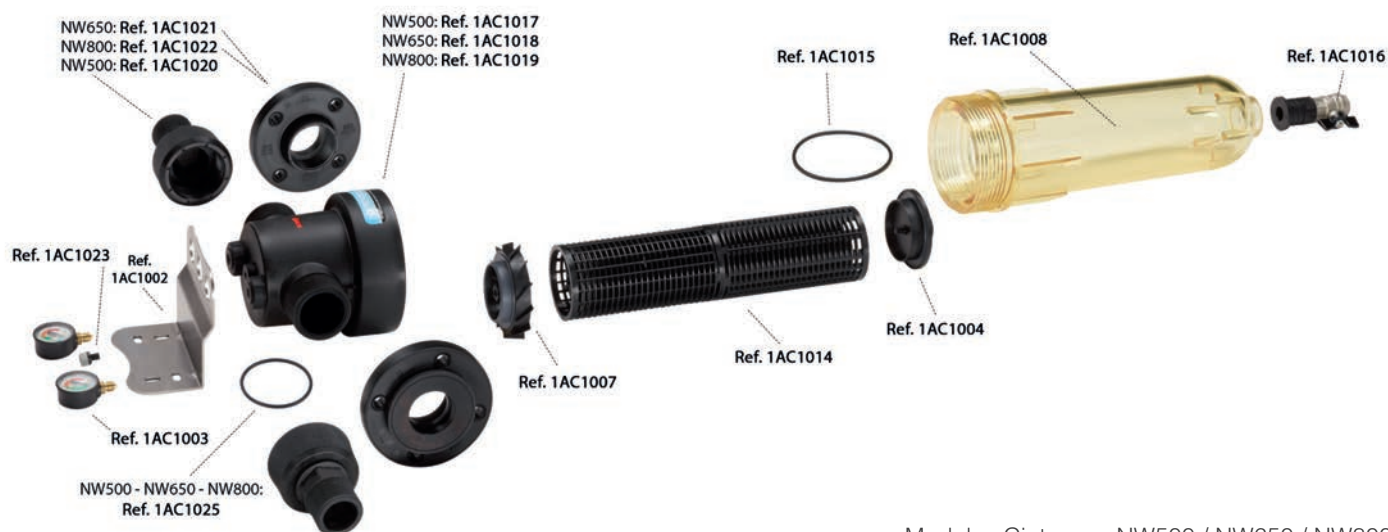

Modelos Cintropur: NW500 / NW650 / NW800
Cintropur models: NW500 / NW650 / NW800